



## The Majestic Murray River

There's no better way to see the Murray River and a slice of the hauntingly beautiful and dramatic Australian outback. Discover the unique flora and fauna, the rich legacy of old riverside ports and indigenous culture close up as you drift unhurried and quietly under the power of the paddle-wheeler PS Murray Princess.

Captain Cook Cruises offers a unique historic and nature-based adventure, past mallee scrub and ancient red gum forests, through towering gorges and ochre-coloured limestone cliffs.

Along the way visit historic ports and lush vineyards as we navigate the Murray's big river bends.

Hike around a boardwalk trail or enjoy a guided nature walk. Take a small boat safari of the lowlands, visit a riverside village, or join all the fun of a riverside barbecue. Don't forget your camera for spectacular river images.

The South Australian food and wine trail is one of the best in the world. Sample some of the river produce at the cellar door or extend your tour to the famous Barossa Valley wineries.

## Reservations

See your Travel Agent or contact Captain Cook Cruises.

## Book online

[www.captaincook.com.au](http://www.captaincook.com.au)

### Central Reservations Australia

E: [reservations@captaincook.com.au](mailto:reservations@captaincook.com.au)

Tel: +61 2 9206 1111

Tel from Australia: 1800 804 843

Tel from New Zealand: 0800 446 389

Fax: +61 2 9206 1178

### Overseas Representatives

New Zealand (Travel Agents only)

Tel: +64 9 459 7441; E: [nz@captaincook.com.au](mailto:nz@captaincook.com.au)

United Kingdom

Tel: +44 0 1483 22 093; E: [uk@captaincook.com.au](mailto:uk@captaincook.com.au)



Captain Cook Cruises (NSW) Pty Ltd ABN 63 001 364 487

No. 6 Jetty, Circular Quay, Sydney NSW 2000 Australia

Tel: +61 2 9206 1111; Fax: +61 2 9251 4725

Email: [cruise@captaincook.com.au](mailto:cruise@captaincook.com.au)

DISCOVERY CRUISES

# Murray River

SOUTH AUSTRALIA

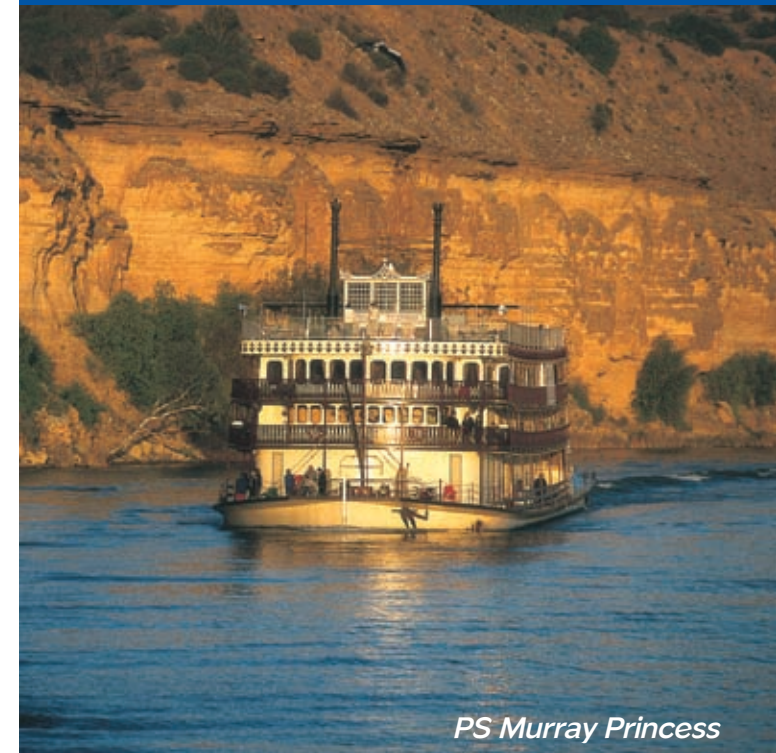

*PS Murray Princess*

*"We felt in touch with the land and its creatures as we snaked along this ancient river"*

[www.captaincook.com.au](http://www.captaincook.com.au)

[www.captaincook.com.au](http://www.captaincook.com.au)



### PS Murray Princess

PS Murray Princess is a true inland paddlewheeler built for the Murray River. Catering to just 120 passengers, she brings the unique advantages of small ship cruising to the Australian outback. 3, 4 & 7 Night cruises depart weekly from Mannum with scenic coach transfers available from Adelaide.

### Facilities

Two spas, two saunas, sun deck; two bars, two lounges, single-sitting dining saloon; speed boat; gift shop, library and video; lift; guest laundry and 24-hour tea and coffee facilities.

### Accommodation

60 cabins and staterooms each with private bathroom ensuite, adjustable air-conditioning, electric blankets, soaps, shampoo and towels; serviced daily. Each cabin is approximately 12 sq metres.

- Staterooms open onto the outside deck and have a fridge and tea and coffee making facilities. All staterooms have a double bed.
- Outside Cabins open onto an outside deck and have picture windows.
- Inside Cabins open onto an inside passageway and have portholes facing the outside.

### Dining

Dining aboard Murray Princess includes delicious blend of buffet and table d'hôte dining.



### SUN DECK

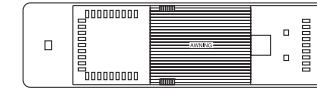

### STURT DECK

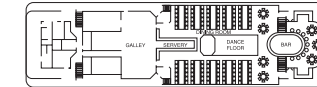

### CADELL DECK

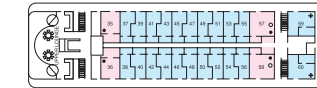

### RANDELL DECK



### CHAFFEY DECK

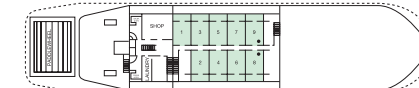

### STATEROOM

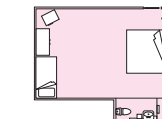

### OUTSIDE CABIN

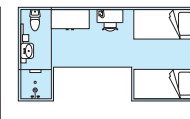

### INSIDE CABIN

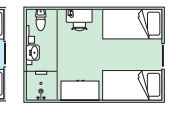

### LEGEND

- Stateroom
- Outside Cabin
- Inside Cabin

All rooms have twin beds unless indicated as follows:

- Extra bed
- Double bed
- ✚ Disabled Facilities