

MURRAY RIVER
PADDLESTEAMERS

— PS EMMYLOU —
Authentic Australian River Cruises



ECHUCA VICTORIA AUSTRALIA
SEASON 2021/22

Luxury Boutique Australian River Cruising

Optional Melbourne Hotel Stay Begins Your Journey

Optional Melbourne Return Transfers

Multi-Course Dining Prepared
By Our Onboard Chef

Complimentary Wine & Beer with Dinner

Riverside Dining & Campfires

Premium Onshore Guided Tours

Authentic Woodfired Paddlesteamer

Daily Historical Commentary

Complimentary Wifi Internet

Maximum 16 Guests Only

Book With
\$400
Per Person



Contents

PS EMMYLOU STORY	2
REGIONALLY INSPIRED DINING	3
MELBOURNE HOTEL PARTNERS	3
CABINS	4
1 NIGHT MURRAY RIVER EXPERIENCE CRUISE	5
2 NIGHT MURRAY RIVER ESCAPE CRUISE	6
3 NIGHT MURRAY RIVER DISCOVER CRUISE	7
4 NIGHT MURRAY RIVER EXPLORER CRUISE	8
6 NIGHT ALL THE RIVERS RUN CRUISE	9
2021-2022 CRUISE DEPARTURES	10
TERMS & CONDITIONS	11



Murray River & PS Emmylou Story

The side wheel paddlesteamers are distinctly Australian having first plied the Murray river in 1853, they established a thriving industry which survived until rail and roads began to service the region near the turn of the century. By 1873 there were 240 boats trading along the Murray River. The inland prospered as trade and commerce developed, and previously out of the way settlements were kept in touch with the cities.

With the introduction of the railway, the paddlesteamers and their industrious crews progressively lost work until the riverboat industry was but a shadow of it's illustrious past.

The Murray River which includes the Darling and Murrumbidgee rivers is one of the longest river systems in the world. Although weirs have cut down the navigability of the river, the Murray alone still claims 2508 kilometres of meandering waters.

PS Emmylou, the world's only wood-fired cruising paddlesteamer reminds us of the romantic days of the paddlesteamers and is now an Australian Icon of the River. Built locally during 1980-82 in the style of the 19th century paddlesteamers, she is perfectly at home at the Port of Echuca, residing with the last few remaining paddlesteamers of the past. She is 30 metres long and 10 metres wide, steel hulled and timber decked.

During 2018 PS Emmylou underwent a specially designed luxury upgrade and fit out. The new contemporary cabins and ensuites include fine linens topped with silky duvets, with the boats' premier cabin, the Emmylou Suite located on the front Upper Deck, with French Doors opening to a deck and 180 degree views of the river.

Guests can enjoy small boat boutique cruising at it's finest with just 16 guests comfortably accommodated in 8 deluxe cabins as PS Emmylou visits places of geographic, historic and Aboriginal cultural significance. Guests will also enjoy onshore tours visiting outstanding local wineries, dropping into local producers and accessing ancient world heritage Murray river tributaries aboard MV Kingfisher with an environmental specialist.

Onboard dining, prepared by the Emmylou's Chef, features local produce and wines from across the Heathcote and Perricoota wine regions. Riverside campfires are offered in the evenings, with stunning night skies to complete this unique experience.

We are proud to continue the tradition of overnight cruising on Australia's greatest waterway with our trademark level of country hospitality aboard an authentic paddlesteamer. We hope you can join us to connect you with Australia's inland history, geography, culture and cuisine.



OPTIONAL
PRE CRUISE
HOTEL STAY



WINE & BEER
WITH DINNER



ONSHORE TOURS



FREE INTERNET



DELICIOUS
REGIONAL CUISINE



COFFEE, TEA
& SNACKS

CONNECT WITH US



@MURRAYRIVERPADDLESTEAMERS



@MURRAYRIVERPS



@MURRAYRIVERPS



MURRAYPADDLESTEAMERS



Regionally Inspired Dining

Inspired by Australia's heartland, our menus take full advantage of our region's diverse bounty of fresh, local ingredients to fashion authentic dishes.

Your Chef takes great care in ensuring all guests dietary requirements are catered for whilst our onboard staff will charm you with traditional Australian country hospitality and attentive service.

A typical day cruising starts with an delightful range of continental choices, including fresh fruit, cereals and pastries or full English breakfast. Your Chef can also cook your favourite omelette or combination to order. Tea, coffee and a range of juices are always included with breakfast.

Lunches range from riverside picnics following onshore tours to extensive multi course dining featuring a choice of mains, salads, pastas, cold meats and deserts.

Dinner is the highlight of the day with multi course 3 to 5 course dinners served with a choice of regionally inspired main meals always offered. On 3, 4 & 6 night cruises you will experience our signature Riverside Grand Dining. Dining under the stars is a special experience as your chef and crew serve you a delicious gourmet Australian BBQ. After dinner relax at the riverside campfire with your fellow passengers toasting marshmallow.

Choose to sit with fellow passengers or with your partner, the choice is yours on all PS Emmylou cruises.

A wide variety of drinks is available including spirits, aperitifs, cocktails and premium wines. On all 2 - 6, night cruises selected wines and beers are complimentary with dinner service. Complimentary barista-made Coffee, Premium Teas, Soft drinks and Bottled Water are available throughout your cruise.

DINING ABOARD EMMYLOU

- Tantalising multi course lunch and dinners
- Bountiful continental and full breakfast options
- Traditional morning and afternoon teas
- Vegetarian and gluten-free menu options
- Fabulous choice of local and Australian wines and beverages
- Free seat dining
- Seasonal alfresco dining with idyllic river views
- Grand riverside dining under the stars on all 3, 4 & 6 night cruises

Melbourne Hotel Partners

We are delighted to be partnering with the Pan Pacific Group with over 40 Hotels across Oceania, Asia & North America.

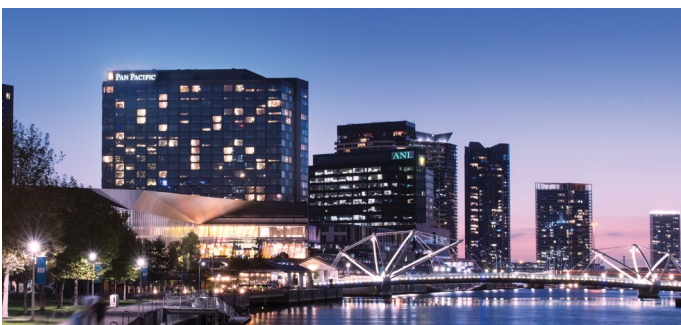

PAN PACIFIC SOUTH WHARF

Discover city of Melbourne along the Yarra River. Enjoy waterfront living at Pan Pacific Melbourne as you explore the South Wharf precinct with fabulous outlet shopping and bustling Melbourne just across the river.

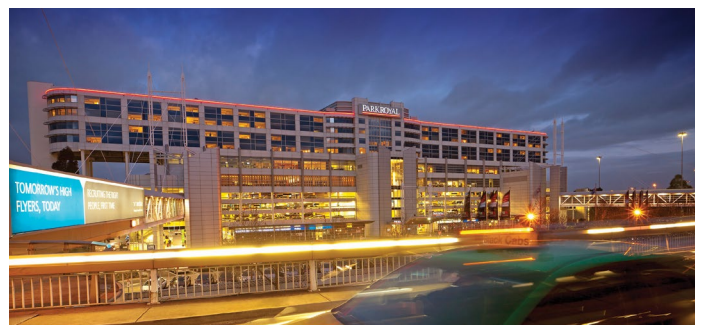

PARKROYAL MELBOURNE AIRPORT

Why rush when your hotel is located so close to the airport. Arrive in style at Parkroyal Melbourne Airport. With direct access to international and domestic terminals you will enjoy convenience like no other.

\$80 per night surcharge applies for weekday stays at Parkroyal Hotel, Melbourne Airport.



Cabins

DELUXE CABINS WITH PRIVATE ENSUITES

Welcome to your home aboard Paddlesteamer Emmylou. We invite you to relax in a warm inviting atmosphere of mid 1800's riverboat charm without sacrificing modern conveniences. Emmylou features contemporary deluxe cabins with fine linens and plush new bedding which will ensure you are well rested to fully enjoy your time aboard with us. Complimentary Wifi is available throughout the boat.

MAIN DECK

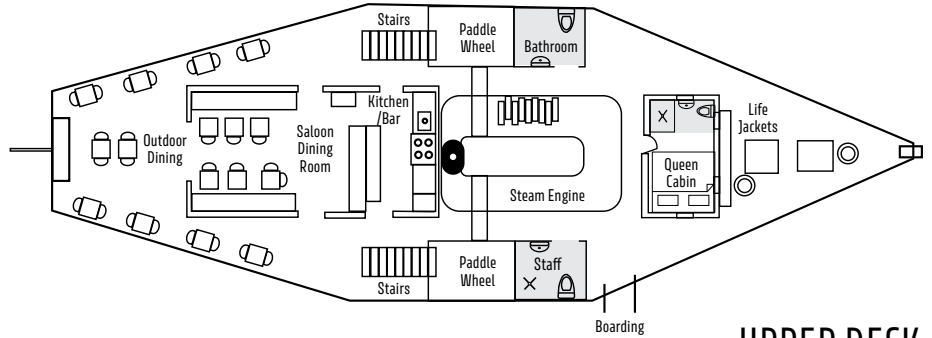

UPPER DECK

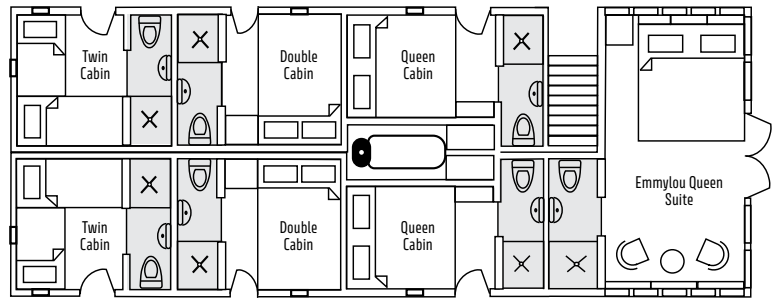

MAIN DECK CABIN

This private Queen Cabin boasts a plush queen bed and private ensuite. The cabin is conveniently situated on the Main Deck with close proximity to the dining Saloon.

UPPER DECK CABINS

Guests enjoying Upper Deck Cabins can choose from Queen, Double & Twin Single Cabins all with private ensuites, with doors opening to the outside affording neighbouring guests the unique opportunity to enjoy a social atmosphere, swapping stories and forming lasting friendships with fellow travellers.

EMMYLOU SUITE

The boats premier accommodation and most spacious. This elegant suite provides a warm ambiance located on the Upper Deck at the front of the boat with French Door opening to the deck. Featuring a seating area, ensuite and plush queen bedding guests can relax with a drink and watch the river banks of the Upper Murray drift by.



Twin Cabin



Double Cabin



Queen Cabin



Emmylou Queen Suite

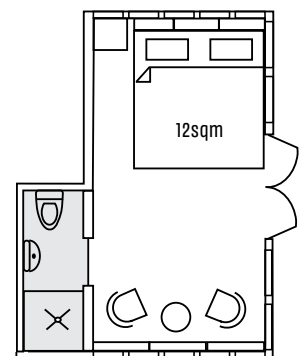
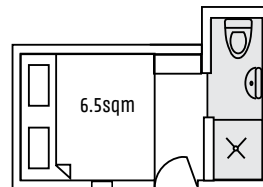
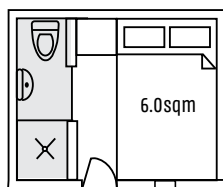
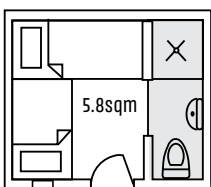



OPTIONAL EXTRAS

Melbourne Hotel Pre Stay & Return Transfers \$870 Per Couple
\$770 Solo Traveller

Melbourne Return Transfers \$620 Per Couple
\$520 Solo Traveller

Bendigo Return Transfers \$420 Per Couple
\$320 Solo Traveller

Self Drive Car Parking \$25 Per Night

SATURDAY DEPARTURES



HIGHLIGHTS

- Spectacular sunset river cruising
- After dinner riverside campfire
- See and hear native Australian wildlife
- Expert historical skipper commentary

INCLUSIONS

- Onboard accommodation
- Chef prepared 5-course dinner
- Fully cooked or continental breakfast
- Complimentary Wifi throughout the boat

PRICES CRUISE ONLY

CABIN TYPE	PP TWIN SHARE	SOLO TRAVELER
Main Queen	\$460	\$736
Upper Twin	\$420	\$672
Upper Double	\$440	\$704
Upper Queen	\$460	\$736
Queen Suite	\$550	NA

1 Night Murray River Experience Cruise -Optional Ex Melbourne

Cruise departs Port of Echuca, Riverboat Dock, Echuca on Saturday at 6.30pm and returns to Echuca on Sunday morning at 9.30am.

FRIDAY – Optional Pre-Cruise Hotel Stay

Today you have time to explore the wonderful city of Melbourne before checking into your Pre Stay Hotel at Pan Pacific South Wharf. Take a free City tram ride, explore Flinders St Station, grab a coffee from one of the many laneway cafés, visit Eureka Sky Deck, National Galley of Victoria and lunch in Chinatown.

SATURDAY – Optional Transfers

Departing at 10.30am from your Hotel you travel to Echuca via Nagambie. Time to explore the many shops, pubs, cafés and historical Port of Echuca before your cruise departs at 6.30pm

After departing from the Port of Echuca you have time for a relaxing drink from the bar or a visit to the wheelhouse to see the Skipper as the sun starts to set over the river. Listen to the river birds evening chorus, watch for kangaroos, egrets and many other species of birds as the stars begin to appear while you enjoy your chef prepared dinner. PS Emmylou powerful floodlights then light the banks of the river as nocturnal wildlife begin to appear.

Please Note: This Cruise does not include any complementary beverages.

After cruising upstream PS Emmylou turns to continue the journey back downstream under the Echuca/Moama Bridge where we pass the imposing Echuca Wharf lit up for the evening and other Paddlesteamers moored after their day on the river.

Relax with a drink on the upper deck or just sit and let the river glide by before Emmylou pulls into her overnight mooring for the evening at Layfield Lane. Here we set up a campfire under the stars where you can enjoy a good yarn with your fellow passengers. Relax with a beverage from the bar or roast marshmallows before retiring for the evening at your leisure.

SUNDAY

Wake to an early morning bush walk or relax over breakfast as we cruise back to Echuca where we reluctantly say farewell arriving back at port at 9.30am. If you have chosen return transfers to Melbourne our coach takes you via the beautiful gold rush City of Bendigo. Here we pause for a coffee run at the trendy Chancery Lane, famous for their art, food and great coffee. The journey then continues to Melbourne for Melbourne Airport or CBD drop offs arriving at 2.30pm.

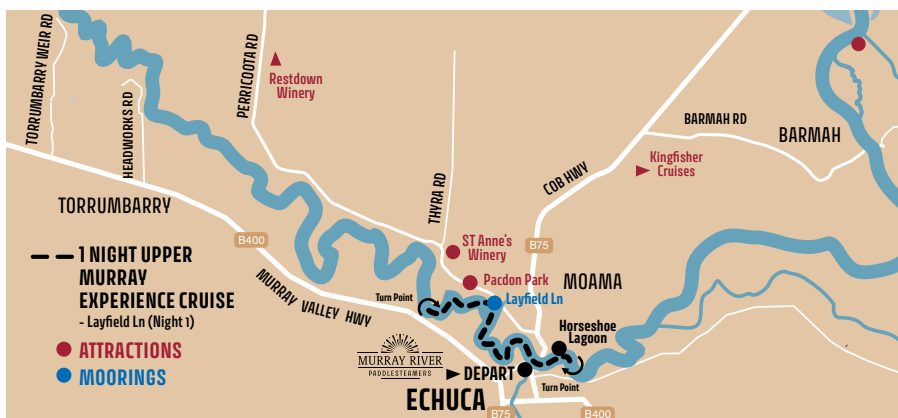



OPTIONAL EXTRAS

Melbourne Hotel Pre Stay & Return Transfers	\$870 Per Couple \$770 Solo Traveller
Melbourne Return Transfers	\$620 Per Couple \$520 Solo Traveller
Bendigo Return Transfers	\$420 Per Couple \$320 Solo Traveller
Self Drive Car Parking	\$25 Per Night

THURSDAY/FRIDAY DEPARTURES



HIGHLIGHTS

- Guided walking tour of Perricoota Station
- After dinner riverside campfire
- See and hear native Australian wildlife
- All day river cruising with historical commentary

INCLUSIONS

- Regionally inspired chef prepared meals
- Selected wine & beer with dinner
- Barista made coffee, tea and soft drinks
- Complimentary Wifi throughout the boat

PRICES CRUISE ONLY

CABIN TYPE	PP TWIN SHARE	SOLO TRAVELER
Main Queen	\$1060	\$1,696
Upper Twin	\$960	\$1,536
Upper Double	\$1010	\$1,616
Upper Queen	\$1060	\$1,696
Queen Suite	\$1,250	NA

2 Night Murray River Escape Cruise

-Optional Ex Melbourne

Cruise departs Port of Echuca, Riverboat Dock, Echuca Thursday (Peak Periods) Friday (Non Peak) at 2.30pm and returns to Echuca at 9.30am.

DAY 1

Departing Echuca downriver, enjoy a welcome afternoon tea with freshly made Australian scones, jam & cream with tea and coffee as you begin to relax and enjoy the sights and sounds of the river. Time to relax or take the opportunity to chat with the Engineer and Skipper in the wheelhouse about the rich history of the river and PS Emmylou. As the sun starts to set over the river, time for an evening cocktail before your chef prepared welcome dinner. Listen to the river birds evening chorus, watch for kangaroos, wombats, egrets and many other species of birds as the stars begin to appear. Tonight, we moor at the famous Perricoota Station. Rich in history, the property was first settled by James Maiden in 1843, and famous for starring in the TV movie "All the River Run" where PS Emmylou was renamed PS Philadelphia.

DAY 2

Early rises and keen photographers are sure to see the morning mist rolling along the river. After breakfast join the Skipper for a guided walking tour of Perricoota Stations buildings and vast gardens.

Learn about the rich history of the property which was once the area's largest sheep and fruit orchard.

Today enjoy a full day cruising the mighty Murray River. You are welcome to join the Skipper in the Wheelhouse to learn how to steer Emmylou along the winding river and chat with the Engineer about how the 1906 Steam Engine powers the boat along the river. Enjoy freshly made scones for morning tea followed by a delicious lunch prepared by your chef.

Tonight, it is time to dress up a little and enjoy a traditional 3 course Dinner with all the trimmings. Enjoy complimentary wines and beers. After dinner, it's Movie Night, with a special presentation of 'Riverboats Remembered' a fabulous historical presentation about the riverboats of the mid 1850's along the Murray River.

You are then welcome to join your fellow passengers around the roaring campfire to watch the stars appear in the stunning night sky before retiring for the evening.

DAY 3

Time for an early morning bush walk or relax over breakfast as we cruise back to Echuca arriving at 9.30am where we reluctantly say farewell.

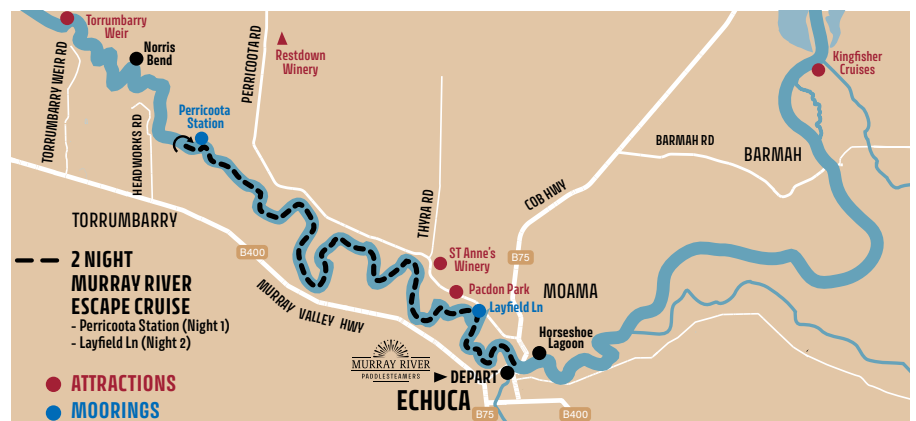



OPTIONAL EXTRAS

Melbourne Hotel Pre Stay & Return Transfers	\$870 Per Couple \$770 Solo Traveller
---------------------------------------------	------------------------------------------

Melbourne Return Transfers	\$620 Per Couple \$520 Solo Traveller
----------------------------	------------------------------------------

Bendigo Return Transfers	\$420 Per Couple \$320 Solo Traveller
--------------------------	------------------------------------------

Self Drive Car Parking	\$25 Per Night
------------------------	----------------

MONDAY DEPARTURES



HIGHLIGHTS

- Riverside grand dining under the stars
- Onshore tour – Eco boat tour & winery visit
- Visit Perricoota Station with garden tour
- After dinner riverside campfire

INCLUSIONS

- Regionally inspired chef prepared meals
- Selected wine & beer with dinner
- Barista made coffee, tea and soft drinks
- Complimentary Wifi throughout the boat

PRICES CRUISE ONLY

CABIN TYPE	PP TWIN SHARE	SOLO TRAVELER
Main Queen	\$1,650	\$2,640
Upper Twin	\$1,550	\$2,480
Upper Double	\$1,600	\$2,560
Upper Queen	\$1,650	\$2,640
Queen Suite	\$1,900	NA

3 Night Murray River Discovery Cruise - Optional Ex Melbourne

Cruise departs Port of Echuca, Riverboat Dock, Echuca on Monday at 2.30pm and returns to Echuca on Thursday morning at 9.30am.

SUNDAY – Optional Pre-Cruise Hotel Stay

Today you have time to explore the wonderful city of Melbourne before checking into your Pre Stay Hotel at Pan Pacific South Wharf.

MONDAY – Optional Transfers

Departing at 10.30am you travel to Echuca arriving to board your cruise departing at 2.30pm.

Departing Echuca downriver, enjoy a welcome afternoon tea as you begin to relax and enjoy the sights and sounds of the river. This evening as the sun begins to set over the river enjoy a cocktail before your welcome dinner. Watch for kangaroos, egrets and many other species of birds as the stars begin to appear. Tonight, we moor at the famous Perricoota Station. Rich in history, the property was first settled by James Maiden in 1843, and famous for starring in the TV movie "All the River Run" where PS Emmylou was renamed PS Philadelphia.

TUESDAY

This morning we depart on a half day excursion travelling to the small town of Barmah for a guided Eco Cruise, where you can get up close to Australian nature and wildlife gliding through the World-Heritage listed Barmah Wetlands aboard the MV Kingfisher. Enjoy a picnic lunch riverside before we

continue to the region's largest winery, St Anne's where you will enjoy a winery tour provided by the owners and taste their fabulous table and fortified wines.

It is then time to re-join PS Emmylou where you can join the Skipper for a guided tour of the gardens and buildings before Emmylou continues upriver towards Deep Creek Marina. Tonight, after dinner, it's Movie Night, with a special presentation of "Riverboats Remembered" a fabulous historical presentation about the riverboats of the mid 1850's along the Murray River.

WEDNESDAY

This morning PS Emmylou departs on a full day of cruising towards our Layfield Lane mooring. Today your welcome to try your hand at steering the boat with the Skipper. Tonight, you will enjoy our signature Grand Dining gourmet Australian BBQ. Enjoy sampling the delicious range of Pacdon Park UK small goods for entrée before enjoying dinner under the stars. After dinner enjoy some yarns sitting around the campfire before retiring for the evening.

THURSDAY

Time for an early morning walk along the riverbank or relax over breakfast as we cruise back to Echuca where we reluctantly say farewell arriving at 9.30am. If you have chosen return transfers to Melbourne your coach will be ready for your return journey to Melbourne Airport or CBD drop offs arriving at 2.30pm.

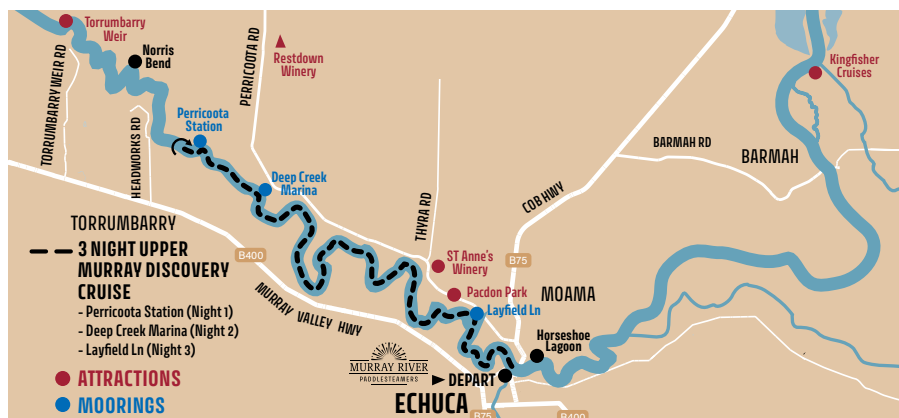



OPTIONAL EXTRAS

Melbourne Hotel Pre Stay & Return Transfers \$870 Per Couple
\$770 Solo Traveller

Melbourne Return Transfers \$620 Per Couple
\$520 Solo Traveller

Bendigo Return Transfers \$420 Per Couple
\$320 Solo Traveller

Self Drive Car Parking \$25 Per Night

MONDAY DEPARTURES



HIGHLIGHTS

- Riverside grand dining under the stars
- Two onshore tours – winery tour & lunch with owners
- World Heritage Wetlands eco boat cruise tour
- Visit Perricoota Station with gardens tour
- After dinner riverside campfire

INCLUSIONS

- Regionally inspired chef prepared meals
- Selected wine & beer with dinner
- Barista made coffee, tea and soft drinks
- Complimentary Wifi throughout the boat

PRICES CRUISE ONLY

CABIN TYPE	PP TWIN SHARE	SOLO TRAVELER
Main Queen	\$2,250	\$3,600
Upper Twin	\$2,150	\$3,440
Upper Double	\$2,200	\$3,520
Upper Queen	\$2,250	\$3,600
Queen Suite	\$2,500	NA

4 Night Murray River Explorer Cruise - Optional Ex Melbourne

Cruise departs Port of Echuca, Riverboat Dock, Echuca on Monday at 2.30pm and returns to Echuca on Thursday morning at 9.30am.

SUNDAY – Optional Pre-Cruise Hotel Stay

Today you have time to explore the wonderful city of Melbourne before checking into your Pre Stay Hotel at Pan Pacific South Wharf.

MONDAY – Optional Transfers

Departing at 10.30am from your Hotel you travel to Echuca arriving at the historical Port of Echuca to board your cruise departing at 2.30pm.

Departing Echuca downriver, enjoy afternoon tea as you begin to relax and enjoy the sights and sounds of the river. This evening enjoy a welcome dinner and watch for kangaroos, egrets and many other species of birds as the stars begin to appear. Tonight, we moor at the famous Perricoota Station. Rich in history, the property was first settled by James Maiden in 1843.

TUESDAY

This morning we depart for Restdown Winery where you will enjoy a guided wetlands walk of early Aboriginal significance followed by a gourmet lunch with wine tastings. We then visit Arbutnot Redgum Sawmill dating back to 1889 before arriving at Torrumbarry Weir where you can learn about the Weir and lock system. This afternoon we cruise towards Norris Bend. After dinner it is movie night, with

"Riverboats Remembered" a fabulous historical presentation about the riverboats of the mid 1850's.

WEDNESDAY

This morning we steam towards Perricoota Station where you can join the Skipper for a guided walking tour of the gardens before we depart to the small town of Barmah. Enjoy a picnic lunch riverside before departing on your guided Eco Cruise, where you can get up close to Australian nature and wildlife gliding through the World-Heritage listed Barmah Wetlands. We continue cruising upriver towards our overnight mooring at Deep Creek Marina.

THURSDAY

This morning we depart for a full days cruising towards our Layfield Lane mooring. Enjoy breakfast on the deck then relax with a good book or just take in the river views and wildlife. Tonight, you will enjoy our signature Grand Dining gourmet Australian BBQ. Enjoy sampling the delicious range of Pacdon Park UK small goods for entrée before enjoying dinner under the stars followed by some yarns sitting around the campfire before retiring for the evening.

FRIDAY

Enjoy an early morning walk along the riverbank before breakfast as we cruise back to Echuca where we reluctantly say farewell arriving at 9.30am. If you have chosen return transfers to Melbourne your coach will be ready for your return journey to Melbourne Airport or CBD drop offs arriving at 2.30pm.

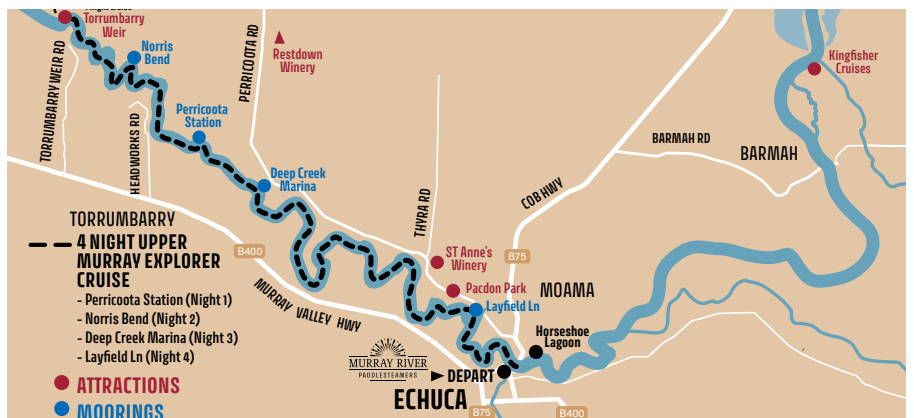



HIGHLIGHTS

- Relive the story of the series with movie nights
- Three onshore tours including a Echuca highlights tour
- Visit Swan Hill Pioneer Settlement & cruise PS Pyap
- Visit Lake Bogo Flying Boat Museum
- All day cruising & after dinner riverside campfires

INCLUSIONS

- Regionally inspired chef prepared meals
- Complimentary "All the River Run" by Nancy Cato
- Selected wine & beer with dinner
- Barista made coffee, tea and soft drinks
- Complimentary Wifi throughout the boat

Cruise departs Echuca Monday's at 2.30pm, returns Sunday morning at 9.30am.

MONDAY

Departing Layfield mooring downriver, enjoy a welcome afternoon tea as you begin to enjoy the sights and sounds of the river. As the sun starts to set over the river, time for an evening cocktail before your chef prepared welcome dinner. Tonight, we moor at Deep Creek Marina with the first of four special movie night presentations of All the Rivers Run.

TUESDAY

This morning we depart on a half day excursion to the small town of Barmah. Here you will depart on a guided Eco Cruise, where you can get up close to Australian nature and wildlife. Enjoy the timeless, natural beauty gliding through the World-Heritage listed Barmah Wetlands followed by a riverside picnic lunch and a visit to St Annes winery for a cellar door tour with the owners. This afternoon we cruise downstream towards Norris Bend.

PRICES

CABIN TYPE	PP TWIN SHARE	SOLO TRAVELER
Main Queen	\$3,450	\$5,520
Upper Twin	\$3,350	\$5,360
Upper Double	\$3,400	\$5,440
Upper Queen	\$3,450	\$5,520
Queen Suite	\$3,750	NA

6 Night All the Rivers Run Cruise

- Optional Ex Melbourne (See Optional Extras)

WEDNESDAY

This morning we cruise towards Torrumbarry Weir departing on our day tour. You will visit Lake Boga Flying Boat Museum and explore Swan Hill Pioneer Settlement with lunch and a cruise aboard PS Pyap. This evening enjoy dinner overlooking the Torrumbarry Weir before enjoying movie night.

THURSDAY

This morning enjoy a walk across the weir visiting the Interpretive Centre learning about the Murray Darling Basin, the Weir and lock system which dates back to 1923 before we depart for an afternoon of river cruising upstream towards Perricoota Station arriving mid afternoon. The property was first settled by James Maiden in 1843 and was made famous for starring in the TV movie "All the Rivers Run" where PS Emmylou was renamed PS Providence. Upon arrival join the Skipper for a guided walking tour of the gardens and buildings learning about the Rich history of the property. Tonight, enjoy drinks on the riverside deck overlooking the river before dinner and movie night.

FRIDAY

This morning PS Emmylou departs on a full day of cruising towards our Layfield Lane.

Try your hand at steering the boat with the Skipper or learning how the 1906 steam engine works with the Engineer.

Tonight, you will enjoy our signature Grand Dining gourmet Australian BBQ. Sample the delicious range of Pacdon Park UK small goods for entrée before relaxing at the riverside grand dining table, star lit by the Southern Cross. After dinner enjoy some yarns sitting around the campfire before retiring for the evening.

SATURDAY

Enjoy breakfast as we cruise towards the Echuca. This morning you depart on a fully narrated tour of Echuca, once the centre of Australia's inland trade and thriving Port. You will visit historical sites and learn about the rich history of this beautiful riverside town. This afternoon we cruise upstream from Echuca exploring the upper river enjoying dinner as the sun sets over the river. Tonight, enjoy the final presentation of All the Rivers Run.

SUNDAY

This morning before breakfast early rises can enjoy a lagoon board walk above Horseshoe Lagoon before PS Emmylou departs for the Port of Echuca where we reluctantly say farewell.

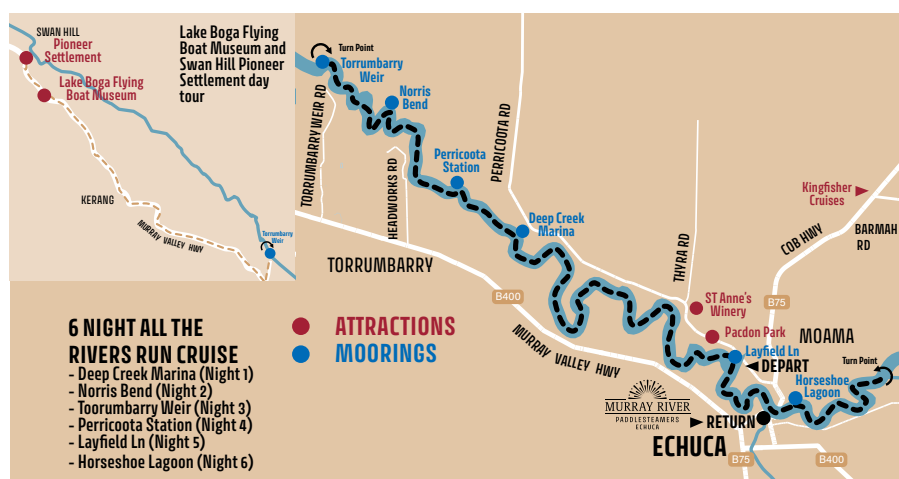

- 6 NIGHT ALL THE RIVERS RUN CRUISE**
- Deep Creek Marina (Night 1)
 - Norris Bend (Night 2)
 - Torrumbarry Weir (Night 3)
 - Perricoota Station (Night 4)
 - Layfield Ln (Night 5)
 - Horseshoe Lagoon (Night 6)

● **ATTRACTIONS**
● **MOORINGS**

2021-2022 Cruise Departures

CRUISE DATES MAY BE SUBJECT TO CHANGE. SUBJECT TO AVAILABILITY

APRIL 2021

M	T	W	T	F	S	S
			1	2	3	4
5	6	7	8	9	10	11
12	13	14	15	16	17	18
19	20	21	22	23	24	25
26	27	28	29	30		

MAY 2021

M	T	W	T	F	S	S
31					1	2
3	4	5	6	7	8	9
10	11	12	13	14	15	16
17	18	19	20	21	22	23
24	25	26	27	28	29	30

JUNE 2021

M	T	W	T	F	S	S
	1	2	3	4	5	6
7	8	9	10	11	12	13
14	15	16	17	18	19	20
21	22	23	24	25	26	27
28	29	30				

JULY 2021

M	T	W	T	F	S	S
			1	2	3	4
5	6	7	8	9	10	11
12	13	14	15	16	17	18
19	20	21	22	23	24	25
26	27	28	29	30	31	

AUGUST 2021

M	T	W	T	F	S	S
30	31					1
2	3	4	5	6	7	8
9	10	11	12	13	14	15
16	17	18	19	20	21	22
23	24	25	26	27	28	29

SEPTEMBER 2021

M	T	W	T	F	S	S
		1	2	3	4	5
6	7	8	9	10	11	12
13	14	15	16	17	18	19
20	21	22	23	24	25	26
27	28	29	30			

OCTOBER 2021

M	T	W	T	F	S	S
				1	2	3
4	5	6	7	8	9	10
11	12	13	14	15	16	17
18	19	20	21	22	23	24
25	26	27	28	29	30	

NOVEMBER 2021

M	T	W	T	F	S	S
1	2	3	4	5	6	7
8	9	10	11	12	13	14
15	16	17	18	19	20	21
22	23	24	25	26	27	28
29	30					

DECEMBER 2021

M	T	W	T	F	S	S
		1	2	3	4	5
6	7	8	9	10	11	12
13	14	15	16	17	18	19
20	21	22	23	24	25	26
27	28	29	30	31		

JANUARY 2022

M	T	W	T	F	S	S
31					1	2
3	4	5	6	7	8	9
10	11	12	13	14	15	16
17	18	19	20	21	22	23
24	25	26	27	28	29	30

FEBRUARY 2022

M	T	W	T	F	S	S
	1	2	3	4	5	6
7	8	9	10	11	12	13
14	15	16	17	18	19	20
21	22	23	24	25	26	27
28						

MARCH 2022

M	T	W	T	F	S	S
	1	2	3	4	5	6
7	8	9	10	11	12	13
14	15	16	17	18	19	20
21	22	23	24	25	26	27
28	29	30	31			

APRIL 2022

M	T	W	T	F	S	S
				1	2	3
4	5	6	7	8	9	10
11	12	13	14	15	16	17
18	19	20	21	22	23	24
25	26	27	28	29	30	

MAY 2022

M	T	W	T	F	S	S
30	31					1
2	3	4	5	6	7	8
9	10	11	12	13	14	15
16	17	18	19	20	21	22
23	24	25	26	27	28	29

JUNE 2022

M	T	W	T	F	S	S
		1	2	3	4	5
6	7	8	9	10	11	12
13	14	15	16	17	18	19
20	21	22	23	24	25	26
27	28	29	30			

JULY 2022

M	T	W	T	F	S	S
				1	2	3
4	5	6	7	8	9	10
11	12	13	14	15	16	17
18	19	20	21	22	23	24
25	26	27	28	29	30	31

AUGUST 2022

M	T	W	T	F	S	S
1	2	3	4	5	6	7
8	9	10	11	12	13	14
15	16	17	18	19	20	21
22	23	24	25	26	27	28
29	30	31				

SEPTEMBER 2022

M	T	W	T	F	S	S
			1	2	3	4
5	6	7	8	9	10	11
12	13	14	15	16	17	18
19	20	21	22	23	24	25
26	27	28	29	30		

OCTOBER 2022

M	T	W	T	F	S	S
31					1	2
3	4	5	6	7	8	9
10	11	12	13	14	15	16
17	18	19	20	21	22	23
24	25	26	27	28	29	30

NOVEMBER 2022

M	T	W	T	F	S	S
	1	2	3	4	5	6
7	8	9	10	11	12	13
14	15	16	17	18	19	20
21	22	23	24	25	26	27
28	29	30				

DECEMBER 2022

M	T	W	T	F	S	S
			1	2	3	4
5	6	7	8	9	10	11
12	13	14	15	16	17	18
19	20	21	22	23	24	25
26	27	28	29	30		

1 NIGHT MURRAY RIVER EXPERIENCE
 2 NIGHT MURRAY RIVER ESCAPE
 3 NIGHT MURRAY RIVER DISCOVERY
 4 NIGHT MURRAY RIVER EXPLORER
 6 NIGHT ALL THE RIVERS RUN

Terms & Conditions

General

The transportation of guests and baggage aboard the vessel/s is governed by these Terms and Conditions. Please carefully read the terms of this cruise agreement.

Your payment of deposit or full fare constitutes agreement to these terms and conditions which includes limitations and exonerations of the liabilities and obligations of Carrier. You should read and understand these terms and conditions carefully before making a deposit. The vessel/s is operated by Australian Paddlesteamers Pty Ltd, trading as Murray River Paddlesteamers (MRPS) and is regularly inspected by the Australian Maritime Safety Authority, AMSA.

Definitions

The terms "you" and "Guests" refer to any and all person(s) named on the front of the Confirmation and include all children or others under the care or control of the named person(s). The term "Carrier" includes Murray River Paddlesteamers, its parent and affiliated entities, the vessels, the owners, charterers, operators, agents, and masters and crews thereof, any substituted or connecting ship, the owners, charterers and operators and all launches belonging to any such boat or owned or operated by the owners, charterers or operators. The term "Fare" includes voyage and shore excursions purchased from Carrier.

Fares are in Australian Dollars, are per guest, are based on double occupancy, and do not include air or land transport.

Single Occupancy Fares carry a 60% surcharge. Port charges are included in the fare. All fares, itineraries, themes, entertainment, shore excursions and other voyage attributes are subject to change without notice and we reserve the right to not honour any published prices that we determine were erroneous due to printing, electronic or clerical error.

Deposit and Final Payment

For confirmation of individual bookings, a non refundable deposit of \$400 of the full fare per person is due upon booking online & within 3 days if booking direct or via a travel agent. The balance of the voyage fare is due ninety days (90) prior to departure date, and all reservations not fully paid at such time will be cancelled and subject to the cancellation provisions set forth in the cancellation policy below. MRPS accepts the following forms of payment: MasterCard, Visa & Bank Transfer. A credit card surcharge between 1.20% - 1.70% maybe incurred for credit card payments depending on the credit card used. Domestic Australian Bank Transfers incur no surcharge or cost. International Bank Transfers incur a minimum A\$15 fee which must be added to the payment made. Bookings made ninety (90) days or less prior to the departure date require payment in full at the time of booking.

Cancellation and Change Policy

Guests who must cancel or change the date of their voyage or any part of their package for any reason, including medical or family reasons, are subject to the fees as outlined below. All fares are based on double occupancy; on reservations in which one guest cancels, the remaining guest is responsible for paying any and all single supplements. MRPS reserves the right to cancel all reservations for which final payment is not received ninety (90) days prior to the departure date.

You acknowledge that your cancellation will cause MRPS difficulty in selling a replacement cruise and thus the cancellation fees herein apply regardless of whether your cruise is resold. You agree that any losses sustained by MRPS in the event of cancellation would be very difficult or impossible to quantify and the cancellation fees are fair and reasonable as liquidated damages. The following cancellation fees will be assessed for all written cancellations received prior to departure up to the scheduled time of departure.

Days Prior to Departure

Up to 91 days	Loss of Deposit
90-31 days	50% of gross fare
30-0 days	100% of gross fare

MRPS recommends that all guests obtain travel insurance for unforeseen circumstances.

Included in your fare

- Bottled water/softdrink*
- All meals • Coffee & Tea*
- Selected Wine & Beer with dinner*
- All standard shore excursions
- Wi-Fi Internet access aboard the vessel
- Gratuities to vessel crew

* 1 Night Cruise Excluded

Not included in your fare

- Airfare to and from your home city
- Alcoholic beverages not stated
- Travel Insurance
- Transfers to and from Melbourne

Payment for additional goods and services must be made prior to the guest's disembarkation. Card only payment. No cash is accepted.

Documentation

Final travel reminder, including itinerary and passenger cruise information guide will be sent two (2) weeks prior to departure. Itineraries are subject to change without notice.

Health & Disability Requirements

Guests must notify MRPS in writing at the time of booking of any physical or mental illness, disability or other conditions for which special accommodations or the use of a wheelchair is necessary or contemplated. Also, we must be notified of any medical treatment that may render the guest unfit for travel or constitute a risk or danger to the guest or anyone else aboard. The vessel does not carry a medical doctor aboard. Acute medical conditions will require you to disembark to be attended to by shore-side emergency and/or medical response. Guests needing any form of assistance and those who are physically disabled must be accompanied by someone who will take full responsibility for any needed assistance during the cruise and in the event of an emergency. We reserve the right to refuse passage to anyone who, in our sole opinion, may affect the health, safety or enjoyment of other guests. Guests requiring a wheelchair must provide their own collapsible wheelchair. Please be aware that some ports of call, shore excursions, docks, gangways and other requirements may preclude a wheelchair guest from leaving the vessel; this decision will be made by the ship's captain and is binding. Also, there may be certain physical conditions, including stairways and narrow passageways within the vessel that may limit or preclude the accessibility of wheelchair guests to some areas. We strongly recommend you purchase travel insurance. With travel insurance, you can plan and enjoy your trip with complete peace of mind.

COVID-19 Health

If at any time a cruise cannot operate due to government-imposed sailing restrictions guests will be offered a future cruise credit for 100% of any funds paid, valid for 18 months of the original departure date. Refunds will not be offered and any extension beyond 18 months will be at Managements discretion. Passengers must complete the Pre-Cruise Health Questionnaire at check-in and comply with management directions, including having their temperature taken before and during the cruise. Guests must comply with the Captains instructions regarding all COVID-19 hygiene and social distancing requirements.

Smoking

Smoking is not permitted anywhere aboard the vessel including inside cabins and suites.

Dining Arrangements

MRPS offer open-seating for breakfast, lunch and dinner. To make a seating request with other guests aboard please contact us.

Gambling

Gambling is not permitted on the Vessel/s.

Animals

Only designated service animals are permitted aboard. You are required to notify MRPS in advance of departure if you plan to bring along a service animal because of a disability. Supporting documents may be requested.

Carrier's Discretion

As the Carrier, we reserve the right at any time, without notice, to cancel any cruise or Cruise Tour, to change or postpone the date or time of sailing or arrival, to change the port of embarkation or final destination, to shorten the cruise or to change or substitute any component of the Cruise Tour. If we are required to do any of these things, we will be responsible to you as follows:

If we cancel the cruise or Cruise Tour before it has started, we will refund the Cruise Fare that we have actually received. If the scheduled sailing date or time is delayed and as a result of that delay, you are not otherwise accommodated on board the Ship, we may arrange hotel accommodations and food at no additional expense to you for the duration of the delay. If the cruise is shortened, we will make a proportionate refund of the Cruise Fare. MRP responsibility does not extend beyond the vessel, and whenever passengers leave it, any arrangements made by them or for them are at their own risk.

Limitation on Carrier's Liability

- (a) No liability for certain events. The Carrier and the vessel/s shall not be liable for loss, death, or delay of, or injury to, any passenger or loss or damage or delay to his/her baggage, personal effects or other property, arising from: acts of God, public enemy, government restraint, riots, strikes, lockouts, labour troubles, whoever may be the instigators thereof, epidemic, civil disturbances of whatever nature, perils of the rivers, or other navigable waters, fuel shortages, collision, stranding, fire, theft, barratry, or any other crime by any person, faults or errors of navigation or management of this or any other vessel, explosions, breakage of shafts or any defect or unseaworthiness in hull, machinery or appurtenances, equipment, furnishings or supplies of the vessel or launches or vehicles or any defect of the Carrier's premises, at whatever time existing, fault or neglect of pilots, tugs, regular members of the crew, agents, servants, independent contractors.
- (b) Limitation on Carrier's liability with respect to baggage and personal property. This liability shall not exceed one hundred Australian Dollars in the event of loss, damage or delay to any of the passenger's baggage or other property taken with him/her on the voyage.

Guest Warranties.

You warrant that you and all other Guests traveling with you are physically, emotionally and otherwise fit to undertake the cruise or Cruise Tour; that you and they have received all medical inoculations necessary; that you and they will at all times comply with the Ship's rules and regulations and orders and directions of the Ship's Captain and officers, and that your conduct will not impair the safety of the Ship or jeopardize or inconvenience other Guests. We may disembark at any time any Guest who may be suffering from contagious or infectious diseases or whose presence, in the opinion of the Captain, may be detrimental to the comfort or safety of other Guests or the crew. In such cases, the Guest shall not be entitled to any refund of the cruise fare or Cruise Tour fare or any compensation whatsoever.

Alcohol Policy

The sale and consumption of alcoholic beverages will be limited to Guests who are 18 years or older. MRPS promotes the responsible service of alcohol and will refuse service to guests if deemed to be intoxicated. Guests are kindly reminded to consume alcohol in moderation. MRPS reserves the right to prohibit and retain all liquor brought onto vessels which is strictly prohibited.

Use of Likeness

Carrier has the exclusive right to use video and other visual/audio portrayals of you or your likeness taken during your cruise in any medium of any nature whatsoever for any purpose, including advertising or promoting the services of Carrier without any compensation being paid to You. Any such portrayal or likeness shall be the exclusive property of the Carrier.

Children

Due to the nature of the cruise and travel itineraries, the Carrier does not maintain facilities or services on its vessels for individuals under the age of 18 years. You must be 18 years old on or before the day you are scheduled to embark on the cruise tour.

Non-Transferrable Tickets

- (a) Your authority to agree. In buying the passenger ticket you state that you are authorised by or on behalf of any passenger listed on the ticket (including any minor) to agree to all the terms and conditions of this agreement.
- (b) No transfer. This agreement is between the Carrier and the passenger. It cannot be sold, assigned or transferred to any other person without prior express written consent of the Carrier.

Australian Consumer Law

Nothing in these Terms and Conditions operates to exclude, restrict or modify any provisions of the Competition and Consumer Act 2010 (Cth) or any equivalent laws applicable in any State or Territory in Australia.

Terms and conditions are subject to change without notice and we are not responsible for errors or omissions therein.



MURRAY RIVER

PADDLESTEAMERS
Authentic Australian River Cruises

MURRAY RIVER PADDLESTEAMERS
57 MURRAY ESPLANADE, ECHUCA VICTORIA 3564
CALL: +61 3 5482 5244
EMAIL: info@mrps.com.au
WEB: psemmyloucruises.com

For reservations contact your travel agent: